

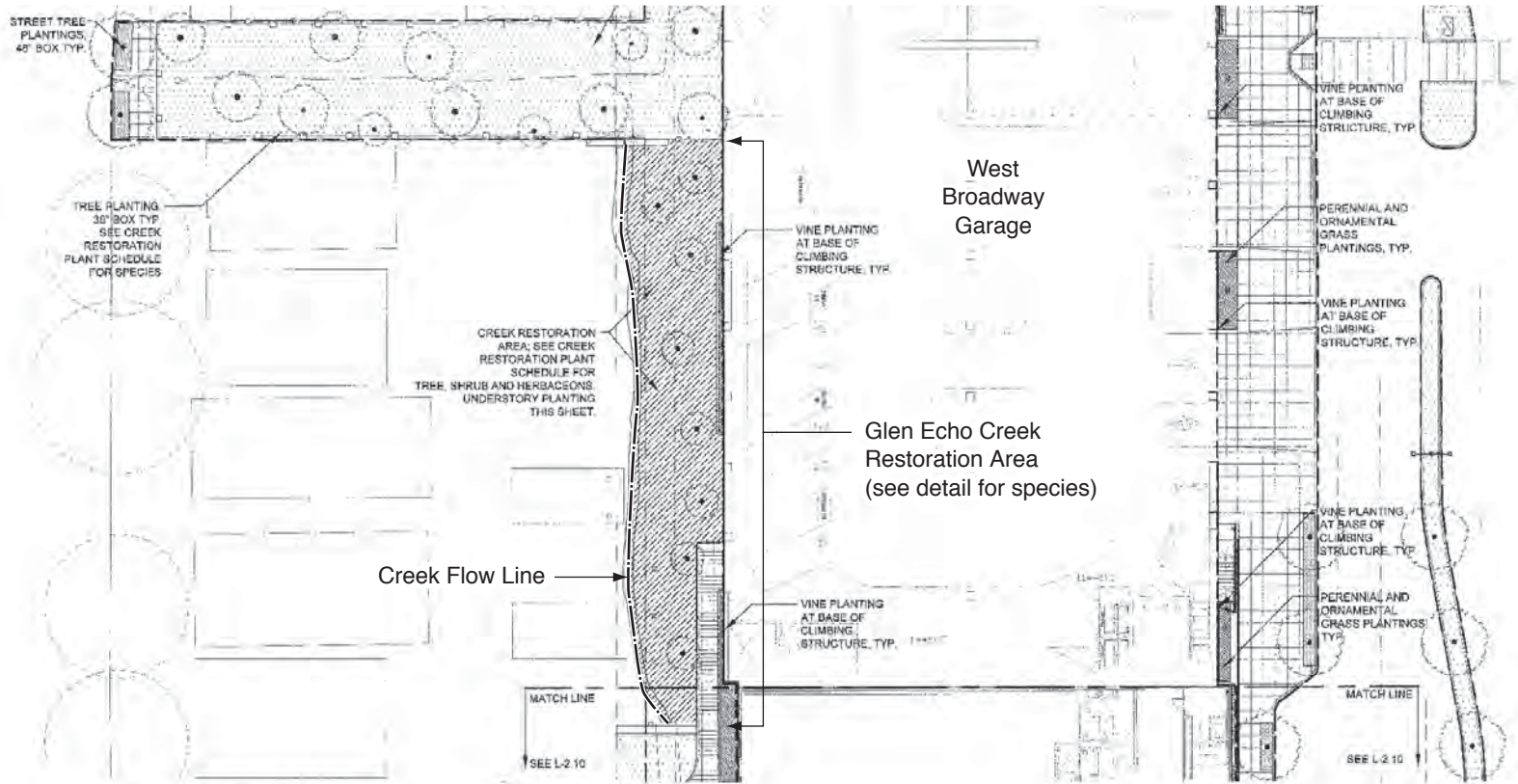

SOURCE: nbj; Interstice Architects

Kaiser Permanente OMC Replacement Project Pre-Construction Notification . 205085

Figure 8
 Conceptual Landscape
 Master Plan



1 GARAGE LANDSCAPE MATERIAL PLAN

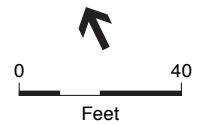

CREEK RESTORATION PLANT SCHEDULE:

SYMBOL	LATIN NAME	COMMON NAME	SIZE	SPACING	REMARKS
TREES					
	<i>Alnus rhombolia</i>	Alder	1.5 gal	20' o.c.	Qty: 3
	<i>Acer macrophyllum</i>	Bogard Maple	5 gal	30' o.c.	Qty: 1
	<i>Alnus rhombolia</i>	Bear Star	5 gal	30' o.c.	Qty: 3
	<i>Pipulus fremontii</i>	Franciscan Cottonwood	5 gal	20' o.c.	Qty: 2
	<i>Amelanchier californica</i>	Redbay	5 gal	20' o.c.	Qty: 3
SHRUB UNDERSTORY					
	<i>Rhamnus californica</i>	California coffeeberry	1 gal	8' o.c.	Qty: 10
	<i>Rosa californica</i>	California rose	1 gal	8' o.c.	Qty: 25
	<i>Rubus ursinus</i>	California blackberry	1 gal	5' o.c.	Qty: 25
	<i>Salix lasiolepis</i>	Red Willow	1 gal	8' o.c.	Qty: 30
	<i>Symphoricarpos elaeagnifolia</i>	Snowberry	1 gal	8' o.c.	Qty: 12
	<i>Cornus sericea</i>	American dogwood	1 gal	8' o.c.	Qty: 4
	<i>Lonicera hispidula</i>	Black hawberry	1 gal	8' o.c.	Qty: 10
	<i>Rhyacophloeus capitulatus</i>	Ninebark	1 gal	8' o.c.	Qty: 10
HERBACEOUS UNDERSTORY					
	<i>Ammannia douglasiana</i>	Mysort	1000ml	3' o.c.	Qty: 30
	<i>Hieracium cranyanthemum</i>	Meadow horsetail	1000ml	2' o.c.	Qty: 75
	<i>Laymus trichoides</i>	Crowfoot willow	1000ml	2' o.c.	Qty: 75
	<i>Arctostaphylos</i>	Yarrow	1000ml	3' o.c.	Qty: 15
	<i>Carum hirsutum</i>	Santa Barbara sedge	1000ml	2' o.c.	Qty: 15
	<i>Scoroparia californica</i>	Castanea figwort	1000ml	5' o.c.	Qty: 5

PLANTING NOTES:

- FOR TYPICAL SIZE SPACING AND SPECIES FOR 30TH STREET AND BROADWAY AVENUE FRONTAGE PLANTINGS SEE PRELIMINARY PLANT SCHEDULE THIS SHEET AS GENERAL REFERENCE.
- SPACING FOR CREEK RESTORATION IS BASED ON AN AVERAGE. ACTUAL SPACING SHALL BE ADJUSTED IN THE FIELD TO ACCOMMODATE OTHER SPECIES. SOME SPECIES ARE TO BE PLANTED IN CLUSTERS.
- PLANT SPECIES FOR MAIN ACCESS & WEST GARAGE LANDSCAPE ARE SIMILAR TO THOSE INDICATED IN CREEK RESTORATION PLANT SCHEDULE ABOVE. SPACING AND SIZES WILL VARY PER NOTES.
- PROVIDE STAKED LAYOUT OF ALL PLANT LOCATIONS FOR REVIEW BY LANDSCAPE ARCHITECT PRIOR TO PLANTING.

SOURCE: nbj



IF THIS SHEET IS NOT 30\"/>



National Facilities Services
Post Office Box 12916
Oakland, California 94604

Revisions
No. Revision By Date Appr.

nbbj

130 Sutter Street, 2nd Floor
San Francisco, CA 94104
(415) 981-1100
(415) 733-2700 fax

INTERSTICE

ARCHITECTURAL, URBAN DESIGN, LANDSCAPE ARCHITECTURE
1411 CAL STREET, SAN FRANCISCO, CALIFORNIA 94108
PH: 415.774.2100 FAX: 415.774.2101 WWW.INTERSTICE.COM

This document is the property of the Owner and is not to be used without owner's written permission.
Project Architect Approval:

Architect/Engineer Of Record:

DESIGN DEVELOPMENT
DECEMBER 5, 2005

Facility
OAKLAND MEDICAL CENTER
280 WEST MACARTHUR BLVD.
OAKLAND, CALIFORNIA 94611
Project
M.O.B. AT 3701 BROADWAY

Sheet Title
GARAGE LANDSCAPE PLANTING PLAN

File No:	Proj No.:	Plan No.:	Subplot:
Scale:	AS NOTED		
Drawn By:	AS		
Checked By:	ZA		
Issue Date:	DEC. 5, 2005		
		KP Proj. No.:	MOB Proj. No.:
		111-976-00	111-976-01
		CADSW: F744	111-976-01
		NBBJ Proj. No.:	50280.00
		Sheet	
		L-2.02	
		Of Sheets	

PRELIMINARY PLANT SCHEDULE:

SYMBOL	LATIN NAME	COMMON NAME	SIZE	SPACING	REMARKS
TREES					
MEL QUIN	<i>Melaleuca quinquenervia</i>	Paperbark	48" box	as shown	multi-stem, matched
OLE EUR	<i>Olea europaea</i> 'Swan Hill'	Fruitless Olive	48" box	as shown	multi-stem, matched
PLA ACE	<i>Platanus x acerifolia</i>	London Plane	48" box	as shown	matched, potential street tree
ULM PAR	<i>Ulmus parvifolia</i>	Chinese Elm	48" box	as shown	matched, potential street tree
BAMBOO					
RAM 1	<i>Phyllostachys</i> sp. - TBD	Tree Bamboo	12 gal.	as shown	SEE PRELIMINARY PLANT SCHEDULE THIS SHEET
RAM 2	<i>Phyllostachys</i> sp. - TBD	Tree Bamboo	15 gal.	as shown	SEE PRELIMINARY PLANT SCHEDULE THIS SHEET
SHRUBS/PERENNIALS					
ESC CAL	<i>Eucalyptus californica</i>	California Poppy	4" pot	varies	
DIE VEG	<i>Dianthus vegeta</i>	Fortnight Lily	1 gal.	varies	
LAV ANG	<i>Lavandula angustifolia</i>	English Lavender	5 gal.	18" o.c.	'Munstead'
LAV INT	<i>Lavandula x intermedia</i>	Hedge Lavender	5 gal.	18" o.c.	'Provence' and 'Grosso'
SAL OFF	<i>Salvia officinalis</i>	Garden Sage	5 gal.	18" o.c.	
ORNAMENTAL GRASSES					
FES CAL	<i>Festuca californica</i>	California Fescue	1 gal.	15" o.c.	'Serpentine Blue'
HEL SEM	<i>Helictotrichon sempervirens</i>	Blue Oat Grass	1 gal.	15" o.c.	
MUH RIG	<i>Muhlenbergia rigens</i>	Dune Grass	5 gal.	2' o.c.	
VINES					
BEA GRA	<i>Besamondia grandiflora</i>	Estrel Lily Vine	5 gal.	2' o.c.	Broadway facade/parking area
DIS LAX	<i>Dalmanella laeviflora</i>	Vanilla Trumpet Vine	5 gal.	18" o.c.	west side of garage
JAS POL	<i>Jasminum polyanthum</i>	Pink Jasmine	5 gal.	18" o.c.	Broadway facade/parking area
PAR QUIN	<i>Parthenocissus quinquefolia</i>	Virginia Creeper	5 gal.	18" o.c.	Engelmann, west side garage
SOL JAS	<i>Solanum jasminoides</i>	Purple Vine	5 gal.	18" o.c.	Broadway facade/parking area
TEO CAP	<i>Tecoma capensis</i>	Cape Honeysuckle	5 gal.	18" o.c.	'Aurea'
VIT CAL	<i>Vitis californica</i>	Wild Grape	1 gal.	18" o.c.	west side of garage
GROUNDCOVER					
SEDUM	<i>Sedum</i> sp.	Sedum	4" pot	8"-12" o.c.	
ECHERAN	<i>Echeveria</i> sp.	Vanilla Trumpet Vine	4" pot	8"-12" o.c.	
MUS	<i>Muscari</i>	Grapehyacinth	4" pot	8"-12" o.c.	
MYO PAR	<i>Myoporum Parviflorum</i>	Myoporum	4" pot	2' o.c.	'Prostratum'

CREEK RESTORATION PLANT SCHEDULE:

SYMBOL	LATIN NAME	COMMON NAME	SIZE	SPACING	REMARKS
TREES					
	<i>Alnus rhombifolia</i>	Alder	5 gal.	20' o.c.	qty: 3
	<i>Acer macrophyllum</i>	Bishop Maple	5 gal.	20' o.c.	qty: 1
	<i>Alnus rhombifolia</i>	Box Elder	5 gal.	20' o.c.	qty: 3
	<i>Populus fremontii</i>	Fremont Cottonwood	5 gal.	20' o.c.	qty: 2
	<i>Aesulus californicus</i>	Buckeye	5 gal.	20' o.c.	qty: 3
SHRUB UNDERSTORY					
	<i>Rhamnus californica</i>	California coffeeberry	1 gal.	5' o.c.	qty: 10
	<i>Rosa californica</i>	California rose	1 gal.	5' o.c.	qty: 25
	<i>Rubus urticus</i>	California blackberry	1 gal.	5' o.c.	qty: 25
	<i>Salix lasiolepis</i>	Red Willow	1 gal.	5' o.c.	qty: 30
	<i>Symphoricarpos sibiricus</i> var. <i>lewisii</i>	Snowberry	1 gal.	5' o.c.	qty: 12
	<i>Cornus sericea</i> ssp. <i>sericea</i>	American dogwood	1 gal.	5' o.c.	qty: 4
	<i>Lonicera involucrata</i> var. <i>subcoccinea</i>	Black hawberry	1 gal.	5' o.c.	qty: 10
	<i>Physocarpus opulifolius</i>	Ninebark	1 gal.	5' o.c.	qty: 10
HERBACEOUS UNDERSTORY					
	<i>Ariemisia douglasiana</i>	Mugwort	supercell	3' o.c.	qty: 30
	<i>Hordeum brachyantherum</i>	Meadow barley	supercell	2' o.c.	qty: 75
	<i>Leymus trichoides</i>	Creeping wildrye	supercell	2' o.c.	qty: 75
	<i>Achilles millefolium</i>	Yarrow	supercell	3' o.c.	qty: 15
	<i>Carex bartera</i>	Santa Barbara sedge	supercell	2' o.c.	qty: 15
	<i>Scrophularia californica</i> ssp. <i>californica</i>	California figwort	supercell	5' o.c.	qty: 5

PLANTING NOTES:

- FOR TYPICAL SIZE SPACING AND SPECIES FOR 38TH STREET AND BROADWAY AVENUE FRONTAGE PLANTINGS SEE PRELIMINARY PLANT SCHEDULE THIS SHEET AS GENERAL REFERENCE.
- SPACING FOR CREEK RESTORATION IS BASED ON AN AVERAGE. ACTUAL SPACING SHALL BE ADJUSTED IN THE FIELD TO ACCOMMODATE OTHER SPECIES. SOME SPECIES ARE TO BE PLANTED IN CLUSTERS.
- PLANT SPECIES FOR MANILA ACCESS & WEST GARAGE LANDSCAPE ARE SIMILAR TO THOSE INDICATED IN CREEK RESTORATION PLANT SCHEDULE ABOVE. SPACING AND SIZES WILL VARY PER NOTES.
- PROVIDE STAKED LAYOUT OF ALL PLANT LOCATIONS FOR REVIEW BY LANDSCAPE ARCHITECT PRIOR TO PLANTING.

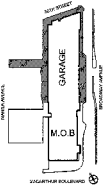

KEY PLAN

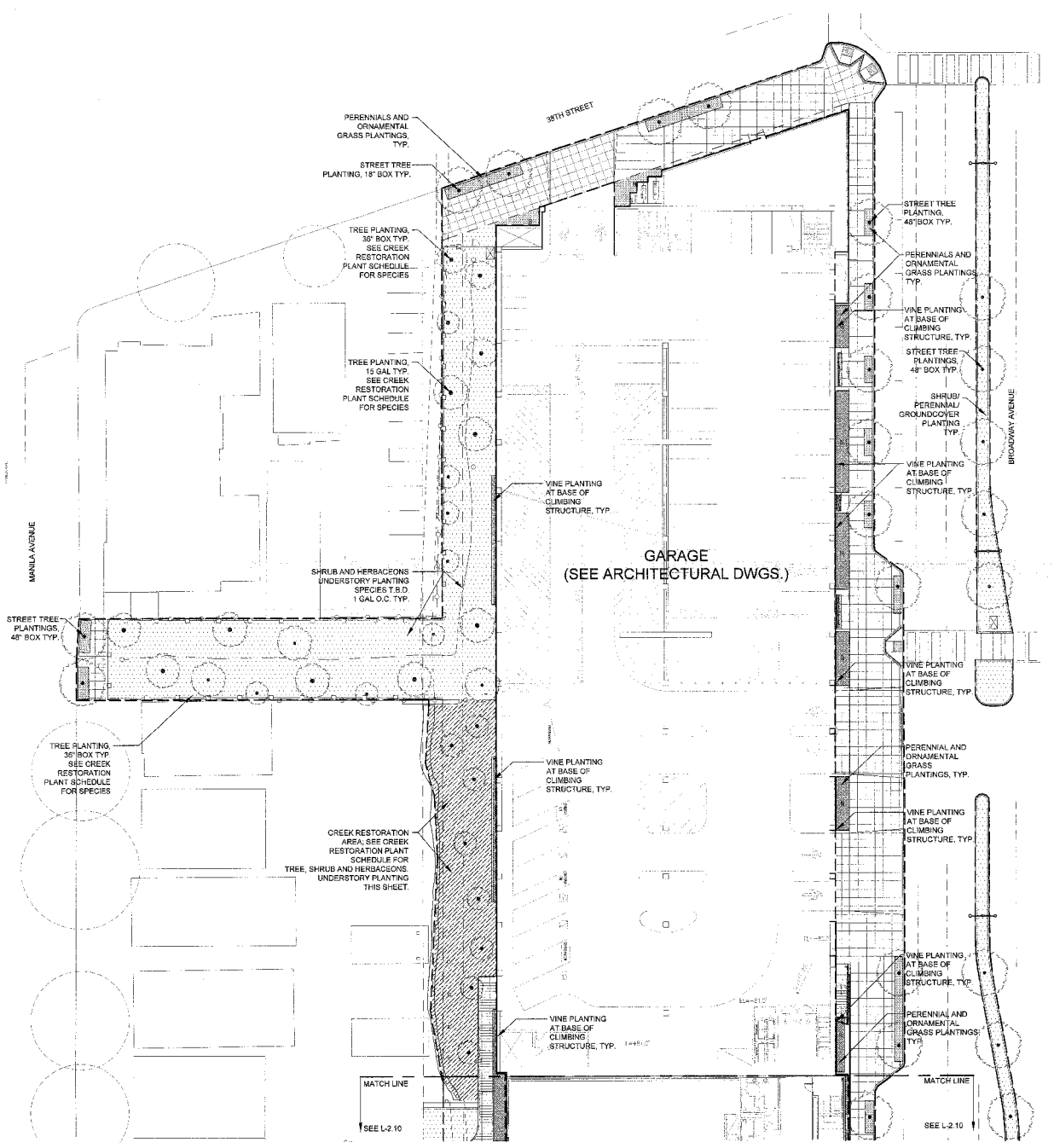

1 GARAGE LANDSCAPE MATERIAL PLAN
Scale: 1/16" = 1'-0"

