

1 RIP-RAP SHORELINE EMBANKMENT WITH WATERFRONT / BAY TRAIL

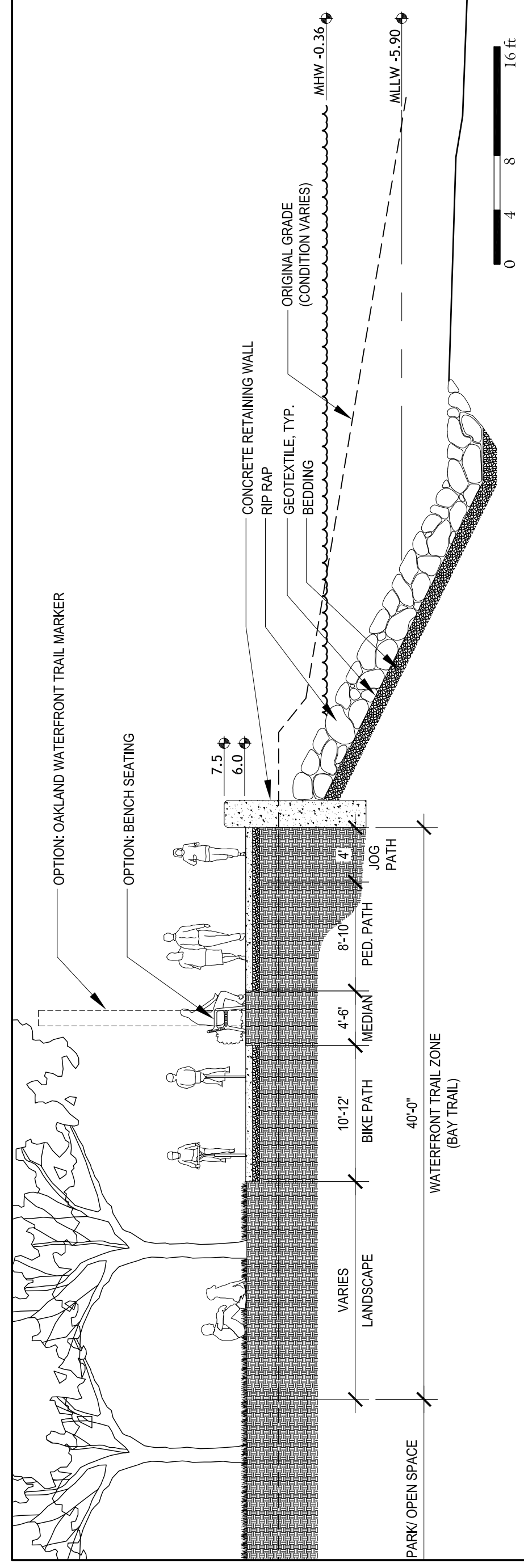

2 ALTERNATE RIP-RAP EDGE WITH RETAINING WALL

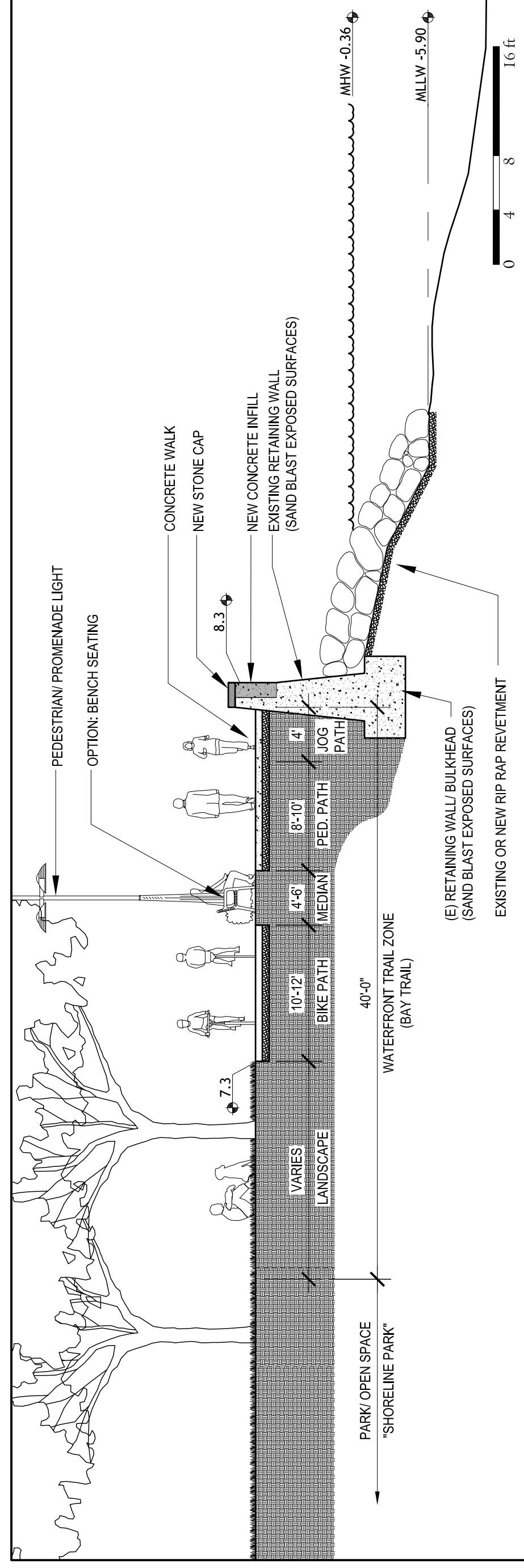

3 WATERFRONT TRAIL AT EXISTING RETAINING WALL

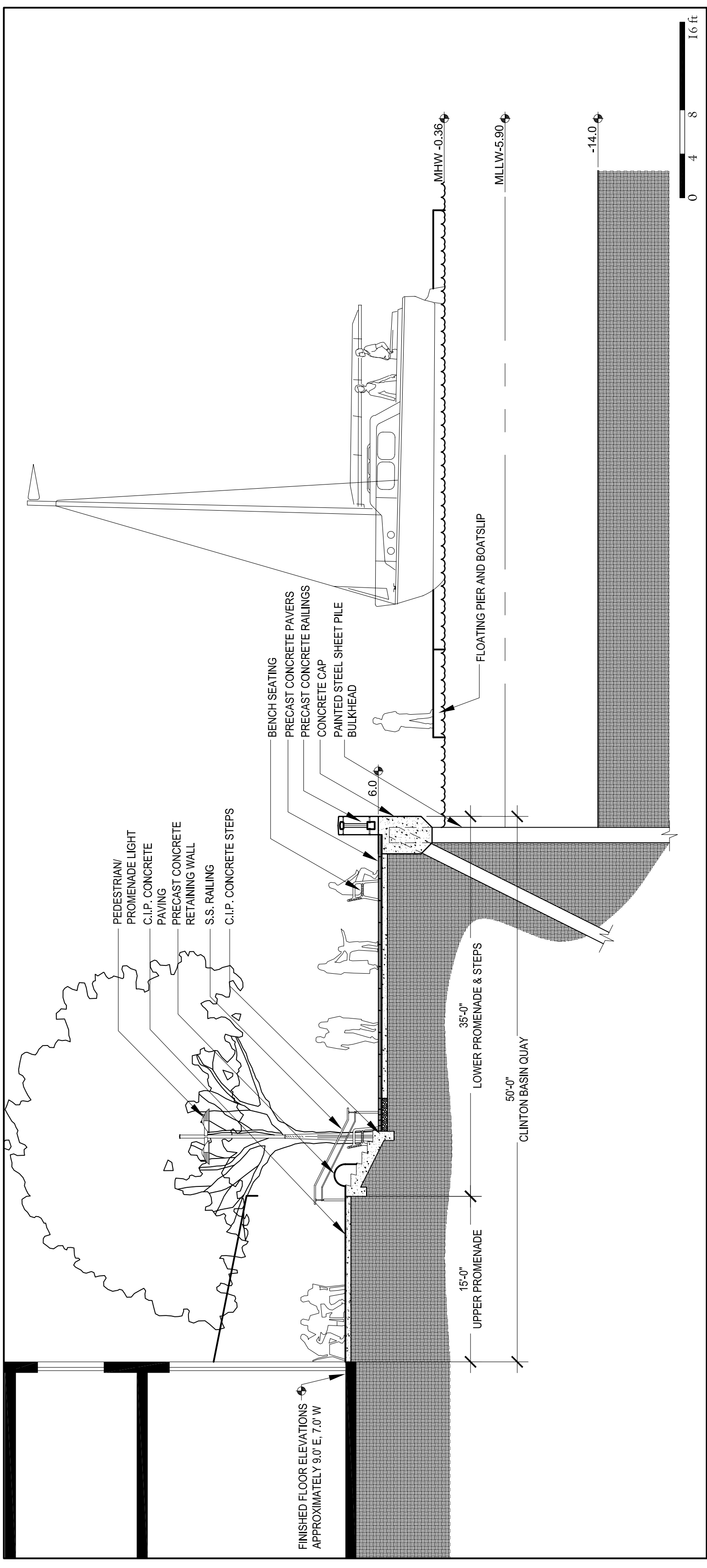

4 CLINTON BASIN QUAY

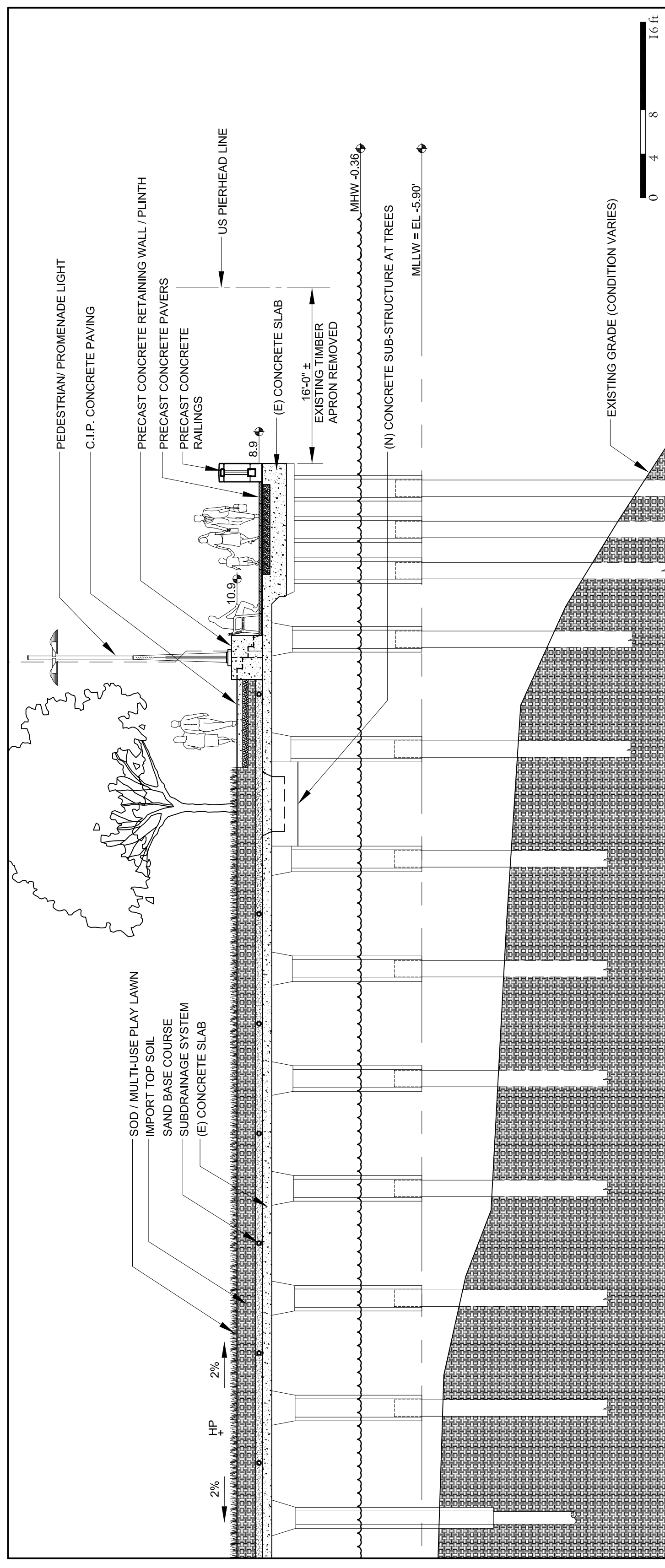

5 9TH AVENUE PIER RETROFIT - TYPICAL SECTION

SHORELINE SECTIONS

Brooklyn Basin - Oak to 9th Development Plan

Prepared for Oakland Harbor Partners by ROMA Design Group in association with MVE Architects, Moffatt & Nichol and BKF Engineers

DECEMBER 2005